

GREENQUEST BY CRYSTAL

Create healthy, sustainable lifestyles through green custom cabinetry from Crystal Cabinets, a manufacturer with a legacy of the strongest environmental ethics in the industry.

Balancing durable cabinetry and environmental responsibility, Crystal offers Green-Core and Green-Core Plus with no-added urea formaldehyde, 100% recycled, low-emitting, and rapidly-renewable cabinet components.

Attesting to its durability, Crystal's green products are backed with a limited lifetime warranty.



WHAT MAKES GREENQUEST CABINETS GREEN?

UV* Water-Based Self-Seal Topcoat

An ultra-low VOC* water-based finish that meets California requirements.



The mark of responsible forestry
Cert no. SGS-COC-005701
© 1996 FSC

Harvested from forests that are well-managed to meet the social, economic and ecological needs of present and future generations.



No added urea-formaldehyde plywood & particleboard

Green-Core plywood and particleboard contains renewable wood fiber with no added urea-formaldehyde resins.

Green-Core plywood is made with a patented soy-based resin and no added urea-formaldehyde.

Green-Core particleboard is 100% recycled with a no added urea-formaldehyde exterior-grade resin.



ESP Certified

Crystal meets the requirements of ESP* 01-06 for Air Quality, Resource Management of Product and Process, Environmental Stewardship and Community Relations and is an approved participant in the KCMA* Environmental Stewardship Program.



Composite Panel Association's Environmentally Preferable Product Downstream Program

Products made with CPA*- certified EPP* composite wood panels are among the greenest you can buy. This seal is your assurance that the products you're getting from Crystal are environmentally responsible.

GREEN Custom Cabinetry

BETTER PRODUCT. BETTER WORLD.



Crystal's GreenQuest construction offers you a multitude of options to design healthy and sustainable custom cabinetry. Create your cabinetry by choosing green materials and features that are especially important to you and your project. **Crystal's GreenQuest products can qualify your project for LEED* credits.**

Cabinet depicted shows a bamboo exterior and natural wood grain melamine interior.

GREEN-CORE & GREEN-CORE PLUS

- No added urea-formaldehyde plywood and particle board box construction option.

FSC WOODS & BOX WORK

- Available in 80 plus doors.
- Available in select wood Species. (Excluding Lyptus)
- Solid wood drawers.

UV* WATER-BASED SELF-SEAL TOPCOAT

- Ultra-low VOC water-based finish.
- Available on all wood door styles.
- Available in Natural finish in standard or flat sheen.

GREEN-GUARD® LAMINATES

Significantly diminishes emissions.

ENGINEERED VENEERS

Engineered veneers are green because they utilize under-valued wood species and are available with Green-Core.

LYPTUS

Harvested from sustainably-managed forests.

BAMBOO

Crystal's bamboo doors can be manufactured using Green-Core substrate. Bamboo meets the LEED definition of rapidly-renewable.

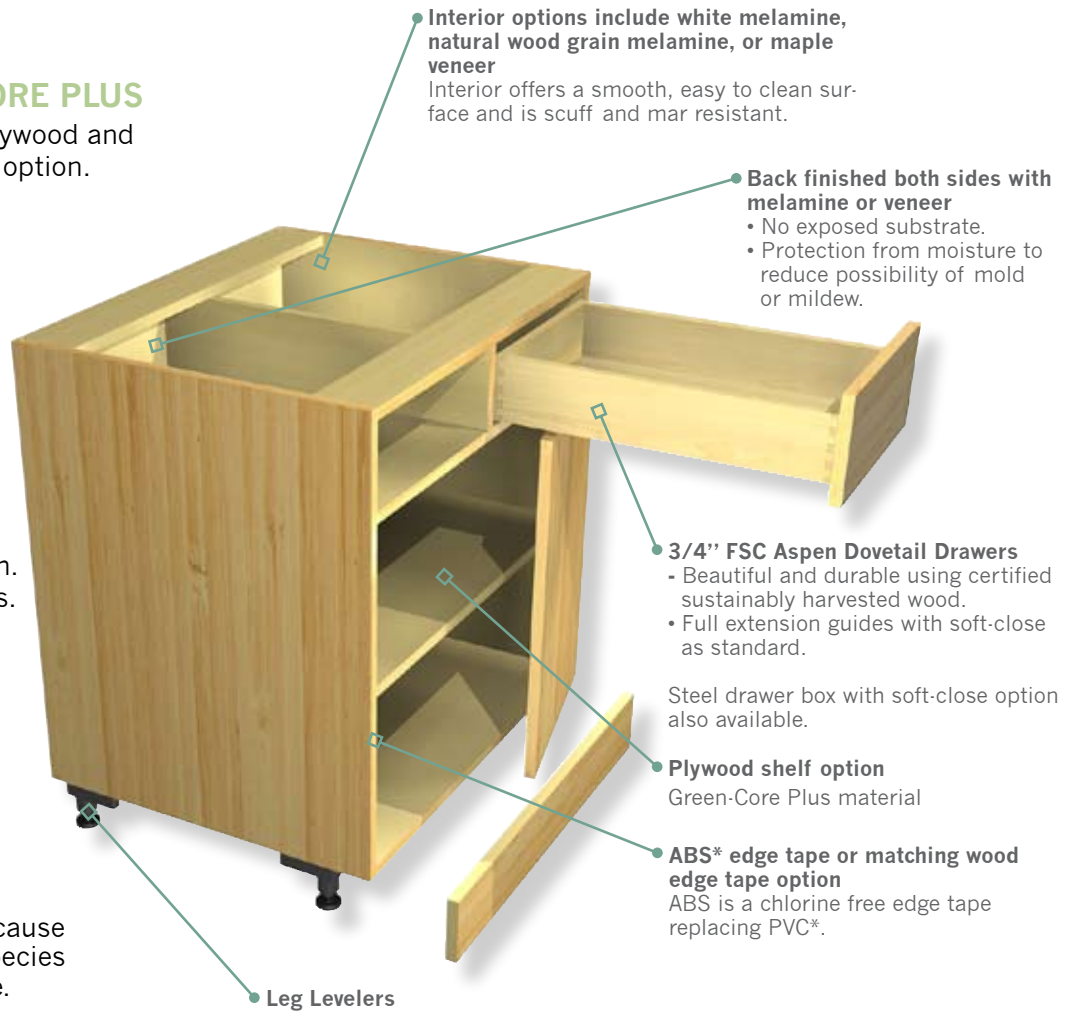

• **Interior options include white melamine, natural wood grain melamine, or maple veneer**

Interior offers a smooth, easy to clean surface and is scuff and mar resistant.

• **Back finished both sides with melamine or veneer**

- No exposed substrate.
- Protection from moisture to reduce possibility of mold or mildew.

• **3/4" FSC Aspen Dovetail Drawers**

- Beautiful and durable using certified sustainably harvested wood.
- Full extension guides with soft-close as standard.

Steel drawer box with soft-close option also available.

• **Plywood shelf option**

Green-Core Plus material

• **ABS* edge tape or matching wood edge tape option**

ABS is a chlorine free edge tape replacing PVC*.

• **Leg Levelers**

Cabinet does not contact floor reducing the chance of mold and mildew from any occurring trapped moisture.

ABS – acrylonitrile butadiene styrene
 CPA – Composite Panel Association
 EPP – Environmentally Preferable Product
 ESP – Environmental Stewardship Program
 FSC – Forest Stewardship Council
 KCMA – Kitchen Cabinet Manufacturers Association
 LEED – Leadership in Energy & Environmental Design
 UV – ultra violet
 PVC – polyvinyl chloride



www.crystalcabinets.com/GreenProducts.htm